



## Assembly and usage instructions



### CONTENTS:

Safety warnings	2
Assembling the trolley	2
Use, maintenance, storage	3
Technical data	3
List of parts	4

### Dear Customer!

Thank you for choosing a product from the Shark Accessories professional accessories range. We believe that you will be satisfied with this product for a long time to come.

### WARNING

**IMPORTANT:** This user manual contains information that is important for the safety of persons and the protection of property.

Before using the trolley, read this entire manual and familiarise yourself with the location and function of the controls!

### CONTENTS:

Safety warning	5
Trolley assembly	5
Use, maintenance, storage	6
Technical data	6
List of parts	4

### Dear customer!

Thank you for choosing a product from the Shark Accessories professional accessories range. We believe that you will be satisfied with this product for a long time to come.

### WARNING

**IMPORTANT:** This user manual contains information that is important for the safety of persons and the protection of property.

Before using the trolley, read this entire manual and familiarise yourself with the location and function of the controls!

## **CZ - ASSEMBLY AND USER MANUAL**

### **SAFETY WARNING**

- When taking delivery of the trolley, please check that no parts are missing and that no components have been damaged during transport.
- Never transport seated or standing persons or animals on the trolley.
- Do not allow children to play on, climb on or climb over the trolley.
- Before driving, always ensure that the trolley is in good technical condition.
- Replace damaged or worn parts immediately with new ones.
- Always check that all bolts, nuts and connecting parts are tight before driving.
- Never exceed the maximum load capacity of the trolley, which is 300 kg.
- When driving with a loaded trolley, avoid dangerous areas, potholes, uneven terrain or steep slopes where the trolley could tip over.
- Always drive slowly and carefully on rough terrain, hills and slippery surfaces.
- Do not drive the trolley into water, over deep ditches or on public roads.
- Prevent injury to persons and/or damage to the trolley – do not exceed a speed of 25 km/h.
- Be careful when loading and unloading the trailer.
- The trailer is only intended to be towed by suitable vehicles (garden tractor, quad bike, UTV).
- Before driving, properly connect and secure the trailer to the towing vehicle's coupling device.
- Always keep your hands and feet away from moving parts while driving and working.
- Always keep the working area around the trailer clean when working.
- Always wear protective equipment, such as safety glasses and work boots, when working with the trolley.

### **ASSEMBLING THE TROLLEY**

- This trolley is delivered unassembled and must be assembled before use.
- Remove the parts from the packaging and check them against the parts list before starting assembly.
- First, attach the body (1) to the chassis frame (2) with screws and nuts (3).
- fit the wheels (4) – insert the washers (5) on both sides of the wheel hub as shown in the diagram and secure with a cotter pin (6).
- Now insert the drawbar (7) into the frame, push through the pin (8) and secure with the cotter pin (6).
- Attach the drawbar (7) to the hitch (9) with bolts and nuts (3).
- Tighten all bolts and nuts. This completes the assembly.

### **WARNING**

**The warnings, cautions and instructions in this manual cannot cover all possible situations that may occur. Therefore, it is necessary to always use common sense when working and to exercise extreme caution when working and driving.**

## USE, MAINTENANCE, STORAGE

### TILTING THE BODY

To tilt the body, pull out the cotter pin and then the safety locking pin and carefully tilt the body backwards.

Before driving, secure the body again with the safety pin and safety pin to prevent accidental tipping of the body while driving.

### MAINTENANCE AND STORAGE

- After each use, clean the trolley of any residue from the transported materials.
- After each use, clean the trolley inside and out to remove mud and hardened dirt.
- Check the tyre pressure before driving. The recommended tyre pressure is 200 kPa.
- Lubricate the swing axles and wheel bearings regularly, more often if necessary.
- Regularly check the tightness of screw connections.
- Clean and lightly lubricate all trolley mechanisms once a year.
- If necessary, repair damaged painted areas with a suitable spray paint.
- Before storing, ensure that the trolley is clean and dry.
- During rainy and winter months, store the trolley in a covered area or in such a way that it is protected from the weather.

### Technical data

- Load capacity 300 kg
- Weight: 45 kg
- Dimensions: 180 x 115 x 76 cm
- Body dimensions: 119 x 93 x 30 cm
- Tyres: 18 x 9.5 - 8
- Tyre pressure: 200 kPa

## DESCRIPTION OF THE MAIN PARTS OF THE TROLLEY

1. Tray
2. Frame
3. Bolts And Nuts
4. Wheel
5. Washer
6. Cotter Pin
7. Tow Bar
8. Pin
9. Hitch Coupler

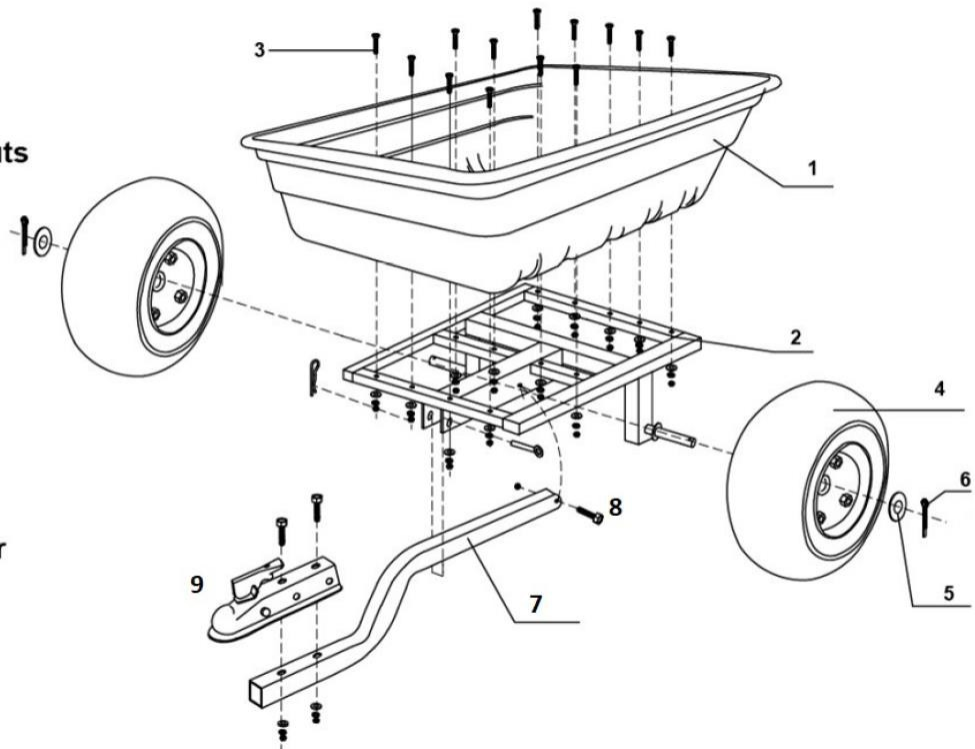

### CZ - Main parts of the trolley:

1	Body	6	Cotter pin
2	Chassis frame	7	Drawbar
3	Screw and nut	8	Tilting pin
4	Wheel	9	Ball hitch (iron)
5	Washer		

### SK - Main parts of the trolley:

1	Body	6	Cotter pin
2	Chassis frame	7	Pull rod
3	Bolts and nuts	8	Tilting pin
4	Wheel	9	Ball hitch
5	Washer		